

THIS DRAWING IS UNPUBLISHED. RELEASED FOR PUBLICATION  
 © COPYRIGHT - By - TE CONNECTIVITY ALL RIGHTS RESERVED.

| LOC | DIST | REVISIONS   |           |     |      |
|-----|------|---|-----------|-----|------|
| P   | LTR  | DESCRIPTION                                       | DATE      | DWN | APVD |
| HB  | -    |   |           |     |      |
|     | E    | REMOVED THE RIB ON THE BASE TO CASE ECO-15-011310 | 04DEC2015 | HYS | CHL  |

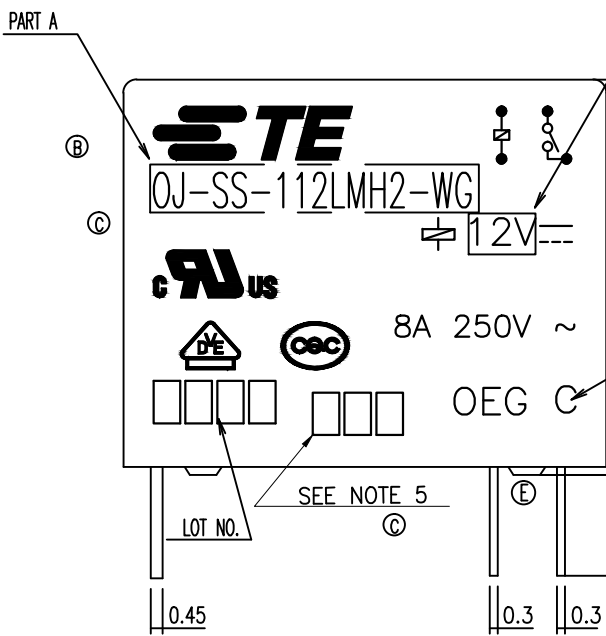
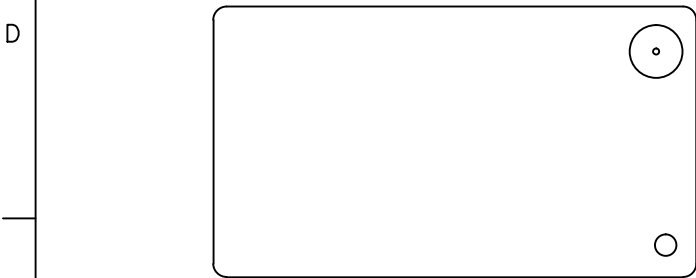

PART B

PART A

C:MADE IN CHINA

LOT NO.

SEE NOTE 5

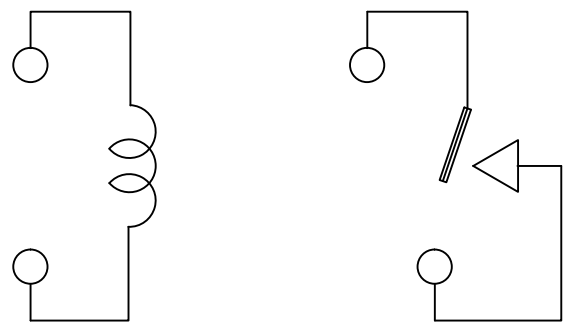
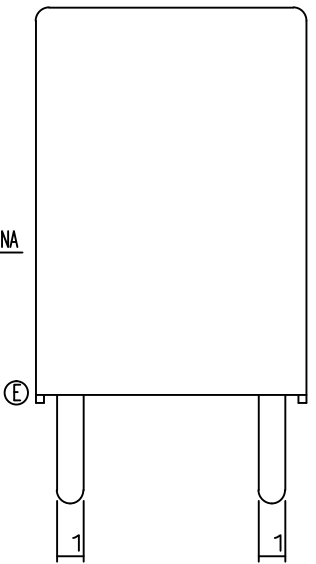

CONNECTION FIGURE

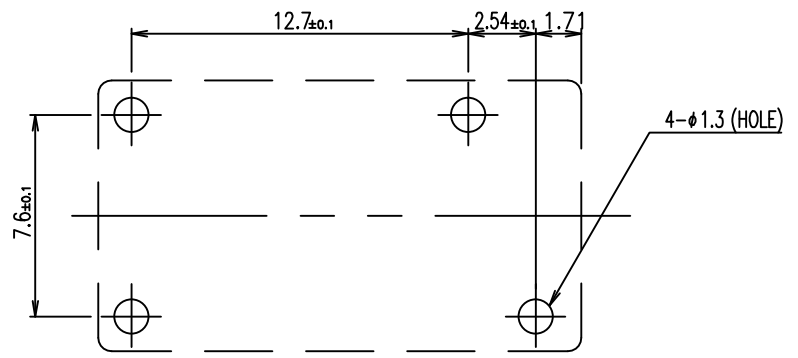
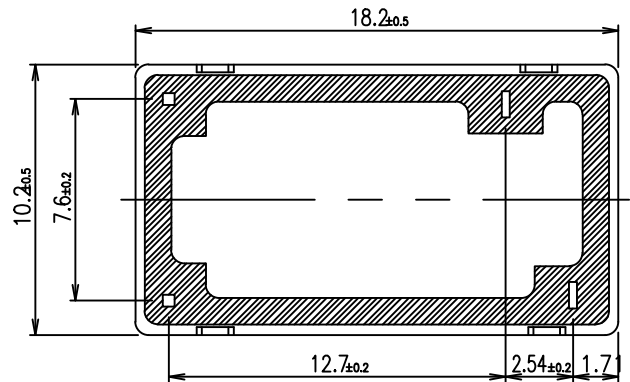

FIGURE FOR PRINTED CIRCUIT BOARD PROCESSING (BOTTOM VIEW)



|  |        |                  |                |           |                           |                        |         |
|--|--------|------------------|----------------|-----------|---------------------------|------------------------|---------|
| THIS DRAWING IS A CONTROLLED DOCUMENT. |        | DWN              | FU.BO          | 24AUG2012 | <b>TE</b> TE Connectivity |                        |         |
| DIMENSIONS: mm                         |        | CHK              | N.FUNAYAMA     | -         |                           |                        |         |
| TOLERANCES UNLESS OTHERWISE SPECIFIED: |        | APVD             | XIAONING.ZHANG | -         | NAME                      |                        |         |
| 0 PLC ± -                              |        | PRODUCT SPEC     | -              |           |                           | OJ-SS-LMH2-WG SPEC,000 |         |
| 1 PLC ± -                              |        | APPLICATION SPEC | -              |           |                           | SIZE                   | A3      |
| 2 PLC ± -                              |        | WEIGHT           | -              |           |                           | CAGE CODE              | 00779   |
| 3 PLC ± -                              |        | CUSTOMER DRAWING | -              |           |                           | DRAWING NO             | 1721874 |
| 4 PLC ± -                              |        |                  | -              |           |                           | RESTRICTED TO          | -       |
| ANGLES ± -                             |        |                  | -              |           |                           | SCALE                  | 5:1     |
| MATERIAL                               | FINISH |                  |                |           | SHEET                     | 1 OF 2                 |         |
| -                                      | -      |                  |                |           | REV                       | E                      |         |

THIS DRAWING IS UNPUBLISHED. RELEASED FOR PUBLICATION - , - .  
 © COPYRIGHT - By - TE CONNECTIVITY ALL RIGHTS RESERVED.

|     |      |           |     |             |      |     |      |
|-----|------|-----------|-----|-------------|------|-----|------|
| LOC | DIST | REVISIONS |     |             |      |     |      |
| HB  | -    | P         | LTR | DESCRIPTION | DATE | DWN | APVD |
|     |      | -         |     | SEE SHEET 1 | -    | -   | -    |

|            |                  |        |                  |      |
|------------|------------------|--------|------------------|------|
| 1721874-6  | OJ-SS-124LMH2-WG | 24V    | OJ-SS-124LMH2-WG | f    |
| 1721874-5  | OJ-SS-112LMH2-WG | 12V    | OJ-SS-112LMH2-WG | e    |
| 1721874-4  | OJ-SS-109LMH2-WG | 9V     | OJ-SS-109LMH2-WG | d    |
| 1721874-3  | OJ-SS-106LMH2-WG | 6V     | OJ-SS-106LMH2-WG | c    |
| 1721874-2  | OJ-SS-105LMH2-WG | 5V     | OJ-SS-105LMH2-WG | b    |
| 1721874-1  | OJ-SS-103LMH2-WG | 3V     | OJ-SS-103LMH2-WG | a    |
| TE PART NO | DESCRIPTION      | PART B | PART A           | TYPE |

| Diagram dimension | Tolerance |
|-------------------|-----------|
| 0.99mm max.       | ±0.1mm    |
| 1 - 2.99mm        | ±0.2mm    |
| 3mm min.          | ±0.3mm    |

RELAY TYPE

|                  |            |             |                      |      |
|------------------|------------|-------------|----------------------|------|
|                  |            | EPOXY RESIN | SEAL (BASE & BOBBIN) | 15   |
|                  |            | MW79        | MAGNETIC WIRE        | 14   |
| 94V-0            |            | NYLON       | CASE                 | 13   |
| 94V-0            |            | P.E.T       | BASE                 | 12   |
| 94V-0            |            | NYLON       | BOBBIN               | 11   |
|                  | SOLDER DIP | C.P WIRE    | COIL TERMINAL        | 10   |
| 94V-0            |            | P.P.S       | CARD                 | 9    |
|                  |            | Ag ALLOY    | MOVABLE CONTACT      | 8    |
|                  |            | Ag ALLOY    | NO.CONTACT           | 7    |
|                  |            | STEEL       | HINGE SPRING         | 6    |
|                  | SOLDER DIP | Cu ALLOY    | NO.TERMINAL          | 5    |
|                  | SOLDER DIP | Cu ALLOY    | MOVABLE SPRING       | 4    |
|                  | NIP        | STEEL       | CORE                 | 3    |
|                  | NIP        | STEEL       | ARMATURE             | 2    |
|                  | NIP        | STEEL       | YOKE                 | 1    |
| INCOMBUSTIBILITY | TREATMENT  | MATERIAL    | DESCRIPTION          | ITEM |

NOTES:  
 1.TERMINAL DIMENSION BEFORE TINNING.  
 2.LOT NO. SYSTEM AS FOLLOWING:

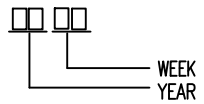

- © 2.TERMINAL DIMENSION IS BEFORE SOLDER DIP;
- © 3.FOR THE TIN-PLATING OF THE PINS:  
 +0.1mm FOR WIDTH,THICKENSS AND DIAMETER.  
 +0.5mm FOR LENGTH.
- © 4.MARKING FROM INK TO LASER AND USING WELDING CONTACT

- © 5.ADD LOT NO. SYSTEM AS FOLLOWING;  
 I, DIGITS FOR DAY OF THE WEEK  
 1...MONDAY IN THIS WEEK;  
 2...TUESDAY IN THIS WEEK;  
 .....  
 7...SUNDAY IN THIS WEEK  
 II, DIGITS FOR SHIFT OF THE DAY  
 1...DAY SHIFT IN THIS DAY;  
 2...NIGHT SHIFT IN THIS DAY;  
 III, ONE CHARACTER DISTINGUISH THE LINE IDENTITY, SUCH AS: A,B.....Z



THIS DRAWING IS A CONTROLLED DOCUMENT.

|                   |  |                           |                        |                    |
|-------------------|--|---------------------------|------------------------|--------------------|
| DIMENSIONS:<br>mm | TOLERANCES UNLESS OTHERWISE SPECIFIED: | DWN<br>FU.BO<br>24AUG2012 | TE Connectivity        |                    |
|                   | 0 PLC ± -                              | CHK<br>N.FUNAYAMA         | OJ-SS-LMH2-WG SPEC,000 |                    |
|                   | 1 PLC ± -                              | APVD<br>XIAONING.ZHANG    | NAME                   |                    |
|                   | 2 PLC ± -                              | PRODUCT SPEC              |                        |                    |
|                   | 3 PLC ± -                              | APPLICATION SPEC          |                        |                    |
| MATERIAL          | FINISH                                 | WEIGHT                    | SIZE<br>A3             | CAGE CODE<br>00779 |
|                   |  |                           | DRAWING NO<br>1721874  | RESTRICTED TO      |
|                   |  | CUSTOMER DRAWING          | SCALE<br>5:1           | SHEET<br>2 OF 2    |
|                   |  |                           | REV<br>E               |                    |